

5 x 2,5 mm 03-1 mm

## ŁAŃCUCH

|        | Podziałka | Szerokość wew. | Rolka Ø |
|--------|-----------|----------------|---------|
| ISO mm | 5,0       | 2,5            | 3,2     |

## KOŁO ŁAŃCUCHOWE

|        | r   | C   | h <sub>1</sub> | L | h <sub>2</sub> | h <sub>3</sub> | H |
|--------|-----|-----|----------------|---|----------------|----------------|---|
| ISO mm | 5,0 | 0,6 | 2,3            | - | -              | -              | - |

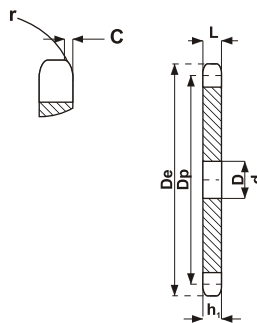

Mat. Stal C45 E UNI EN1083-1

ISO R606/ DIN 8187

| Z  | De   | Dp    | 1 - rzędowe |
|----|------|-------|-------------|
|    |      |       | D           |
| 8  | 15,2 | 13,06 | 4           |
| 9  | 16,8 | 14,62 | 4           |
| 10 | 18,3 | 16,18 | 4           |
| 11 | 19,9 | 17,75 | 5           |
| 12 | 21,5 | 19,32 | 5           |
| 13 | 23,0 | 20,89 | 5           |
| 14 | 24,6 | 22,47 | 5           |
| 15 | 26,2 | 24,04 | 5           |
| 16 | 27,8 | 25,63 | 6           |
| 17 | 29,4 | 27,20 | 6           |
| 18 | 30,9 | 28,79 | 6           |
| 19 | 32,5 | 30,38 | 6           |
| 20 | 34,1 | 31,96 | 6           |
| 21 | 35,7 | 33,54 | 8           |
| 22 | 37,3 | 35,13 | 8           |
| 23 | 38,9 | 36,72 | 8           |
| 24 | 40,5 | 38,30 | 8           |
| 25 | 42,0 | 39,89 | 8           |
| 26 | 43,6 | 41,48 | 8           |
| 27 | 45,2 | 43,07 | 8           |
| 28 | 46,8 | 44,65 | 8           |
| 29 | 48,4 | 46,25 | 8           |
| 30 | 50,0 | 47,83 | 8           |
| 31 | 51,5 | 49,42 | 8           |
| 32 | 53,2 | 51,01 | 8           |
| 33 | 54,8 | 52,60 | 8           |
| 34 | 56,3 | 54,19 | 8           |
| 35 | 57,9 | 55,78 | 8           |
| 36 | 59,5 | 57,37 | 8           |
| 37 | 61,1 | 58,96 | 8           |
| 38 | 62,7 | 60,54 | 8           |
| 39 | 64,3 | 62,13 | 8           |
| 40 | 65,9 | 63,73 | 8           |
| 41 | 67,5 | 65,31 | 8           |
| 42 | 69,1 | 66,91 | 8           |
| 43 | 70,6 | 68,49 | 8           |

| Z   | De    | Dp     | 1 - rzędowe |
|-----|-------|--------|-------------|
|     |       |        | D           |
| 44  | 72,2  | 70,09  | 8           |
| 45  | 73,8  | 71,68  | 8           |
| 46  | 75,4  | 73,27  | 8           |
| 47  | 77,0  | 74,86  | 8           |
| 48  | 78,6  | 76,45  | 8           |
| 49  | 80,2  | 78,03  | 8           |
| 50  | 81,8  | 79,63  | 8           |
| 51  | 83,4  | 81,22  | 10          |
| 52  | 85,0  | 82,81  | 10          |
| 53  | 86,6  | 84,40  | 10          |
| 54  | 88,0  | 85,97  | 10          |
| 55  | 89,7  | 87,58  | 10          |
| 56  | 91,3  | 89,17  | 10          |
| 57  | 92,9  | 90,76  | 10          |
| 58  | 94,5  | 92,35  | 10          |
| 59  | 96,1  | 93,94  | 10          |
| 60  | 97,7  | 95,53  | 10          |
| 62  | 100,9 | 98,72  | 12          |
| 64  | 104,1 | 101,90 | 12          |
| 65  | 105,6 | 103,49 | 12          |
| 66  | 107,2 | 105,08 | 12          |
| 68  | 110,4 | 108,26 | 12          |
| 70  | 113,6 | 111,44 | 12          |
| 72  | 116,8 | 114,63 | 12          |
| 75  | 121,6 | 119,40 | 12          |
| 76  | 123,1 | 120,99 | 12          |
| 78  | 126,3 | 124,17 | 12          |
| 80  | 129,5 | 127,35 | 12          |
| 85  | 137,5 | 135,31 | 14          |
| 90  | 145,4 | 143,27 | 14          |
| 95  | 153,4 | 151,22 | 14          |
| 100 | 161,3 | 159,18 | 14          |
| 110 | 177,2 | 175,09 | 14          |
| 114 | 183,6 | 181,46 | 14          |
| 120 | 193,2 | 191,01 | 14          |
| 125 | 201,1 | 198,96 | 14          |

6 x 2,8 mm 04-1 mm

## ŁAŃCUCH

|        | Podziałka | Szerokość wew. | Rolka Ø |
|--------|-----------|----------------|---------|
| ISO mm | 6,0       | 2,8            | 4,0     |

## KOŁO ŁAŃCUCHOWE

|        | r   | C   | h <sub>1</sub> | L | h <sub>2</sub> | h <sub>3</sub> | H |
|--------|-----|-----|----------------|---|----------------|----------------|---|
| ISO mm | 6,0 | 0,7 | 2,6            | - | -              | -              | - |

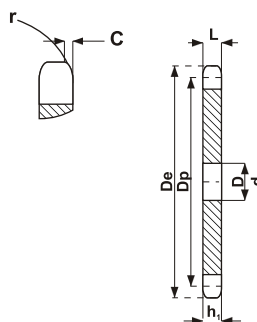

Mat. Stal C45 E UNI EN1083-1

ISO R606/ DIN 8187

| Z  | De   | Dp    | 1 - rzędowe |
|----|------|-------|-------------|
|    |      |       | D           |
| 8  | 18,0 | 15,67 | 5           |
| 9  | 19,9 | 17,54 | 5           |
| 10 | 21,7 | 19,42 | 6           |
| 11 | 23,7 | 21,30 | 6           |
| 12 | 25,4 | 23,18 | 6           |
| 13 | 27,3 | 25,05 | 8           |
| 14 | 29,2 | 26,96 | 8           |
| 15 | 31,1 | 28,86 | 8           |
| 16 | 33,0 | 30,76 | 8           |
| 17 | 35,0 | 32,65 | 8           |
| 18 | 36,9 | 34,55 | 8           |
| 19 | 38,8 | 36,44 | 8           |
| 20 | 40,7 | 38,34 | 8           |
| 21 | 42,6 | 40,25 | 8           |
| 22 | 44,5 | 42,16 | 8           |
| 23 | 46,4 | 44,06 | 8           |
| 24 | 48,3 | 45,96 | 8           |
| 25 | 50,2 | 47,87 | 8           |
| 26 | 52,1 | 49,77 | 8           |
| 27 | 54,0 | 51,67 | 8           |
| 28 | 55,9 | 53,58 | 8           |
| 29 | 57,8 | 55,50 | 8           |
| 30 | 59,8 | 57,42 | 8           |
| 31 | 61,7 | 59,31 | 8           |
| 32 | 63,6 | 61,21 | 8           |
| 33 | 65,5 | 63,11 | 8           |
| 34 | 67,4 | 65,02 | 8           |
| 35 | 69,3 | 66,93 | 8           |
| 36 | 71,2 | 68,84 | 8           |
| 37 | 73,1 | 70,75 | 8           |
| 38 | 75,0 | 72,66 | 8           |
| 39 | 76,9 | 74,56 | 8           |
| 40 | 78,9 | 76,47 | 8           |
| 41 | 80,8 | 78,38 | 10          |
| 42 | 82,7 | 80,28 | 10          |
| 43 | 84,7 | 82,19 | 10          |

| Z   | De    | Dp     | 1 - rzędowe |
|-----|-------|--------|-------------|
|     |       |        | D           |
| 44  | 86,6  | 84,10  | 10          |
| 45  | 88,5  | 86,01  | 10          |
| 46  | 90,4  | 87,92  | 10          |
| 47  | 92,3  | 89,83  | 10          |
| 48  | 94,2  | 91,74  | 10          |
| 49  | 96,1  | 93,64  | 10          |
| 50  | 98,0  | 95,55  | 10          |
| 51  | 99,9  | 97,47  | 12          |
| 52  | 101,8 | 99,37  | 12          |
| 53  | 103,7 | 101,27 | 12          |
| 54  | 105,6 | 103,17 | 12          |
| 55  | 107,6 | 105,08 | 12          |
| 56  | 109,5 | 107,00 | 12          |
| 57  | 111,4 | 108,93 | 12          |
| 58  | 113,3 | 110,82 | 12          |
| 59  | 115,2 | 112,71 | 12          |
| 60  | 117,1 | 114,62 | 12          |
| 62  | 120,9 | 118,45 | 14          |
| 64  | 124,7 | 122,27 | 14          |
| 65  | 126,6 | 124,18 | 14          |
| 66  | 128,5 | 126,09 | 14          |
| 68  | 132,4 | 129,91 | 14          |
| 70  | 136,2 | 133,73 | 14          |
| 72  | 140,0 | 137,55 | 16          |
| 75  | 145,7 | 143,28 | 16          |
| 76  | 147,6 | 145,19 | 16          |
| 78  | 151,5 | 149,01 | 16          |
| 80  | 155,3 | 152,82 | 16          |
| 85  | 164,8 | 162,37 | 16          |
| 90  | 174,4 | 171,92 | 16          |
| 95  | 183,9 | 181,47 | 16          |
| 100 | 193,5 | 191,01 | 16          |
| 110 | 211,6 | 210,11 | 16          |
| 114 | 220,2 | 217,75 | 16          |
| 120 | 231,7 | 229,20 | 16          |
| 125 | 241,2 | 238,75 | 16          |

1/4" x 1/8" ASA 25-1 6,35 x 3,18 mm

## ŁAŃCUCH

|           | Podziałka | Szerokość wew. | Rolka Ø |
|-----------|-----------|----------------|---------|
| ASA 25 mm | 6,35      | 3,18           | 3,30    |

## KOŁO ŁAŃCUCHOWE

|        | r   | C   | h <sub>1</sub> | L | h <sub>2</sub> | h <sub>3</sub> | H |
|--------|-----|-----|----------------|---|----------------|----------------|---|
| ISO mm | 6,4 | 0,7 | 2,9            | - | -              | -              | - |

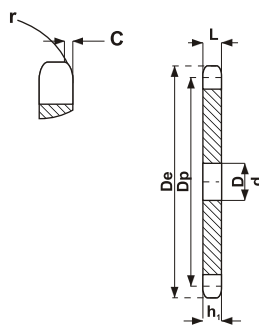

Mat. Stal C45 E UNI EN1083-1

ISO R606/ DIN 8187

| Z  | De   | Dp    | 1 - rzędowe |
|----|------|-------|-------------|
|    |      |       | D           |
| 8  | 19,4 | 16,58 | 6           |
| 9  | 21,4 | 18,56 | 6           |
| 10 | 23,3 | 20,55 | 6           |
| 11 | 25,3 | 22,54 | 8           |
| 12 | 27,3 | 24,53 | 8           |
| 13 | 29,3 | 26,53 | 8           |
| 14 | 31,3 | 28,53 | 8           |
| 15 | 33,3 | 30,55 | 8           |
| 16 | 35,3 | 32,55 | 8           |
| 17 | 37,3 | 34,55 | 8           |
| 18 | 39,4 | 36,56 | 8           |
| 19 | 41,4 | 38,58 | 8           |
| 20 | 43,4 | 40,58 | 8           |
| 21 | 45,4 | 42,60 | 8           |
| 22 | 47,4 | 44,62 | 8           |
| 23 | 49,4 | 46,63 | 8           |
| 24 | 51,4 | 48,64 | 8           |
| 25 | 53,3 | 50,66 | 8           |
| 26 | 55,5 | 52,67 | 8           |
| 27 | 57,5 | 54,69 | 8           |
| 28 | 59,5 | 56,71 | 8           |
| 29 | 61,5 | 58,73 | 8           |
| 30 | 63,6 | 60,75 | 8           |
| 31 | 65,6 | 62,76 | 10          |
| 32 | 67,6 | 64,78 | 10          |
| 33 | 69,6 | 66,80 | 10          |
| 34 | 71,6 | 68,82 | 10          |
| 35 | 73,6 | 70,84 | 10          |
| 36 | 75,6 | 72,85 | 10          |
| 37 | 77,7 | 74,87 | 10          |
| 38 | 79,7 | 76,89 | 10          |
| 39 | 81,7 | 78,91 | 10          |
| 40 | 83,7 | 80,93 | 10          |
| 41 | 85,7 | 82,95 | 10          |
| 42 | 87,8 | 84,97 | 10          |
| 43 | 89,8 | 86,98 | 10          |

| Z   | De    | Dp     | 1 - rzędowe |
|-----|-------|--------|-------------|
|     |       |        | D           |
| 44  | 91,8  | 89,01  | 10          |
| 45  | 93,8  | 91,03  | 10          |
| 46  | 95,8  | 93,05  | 10          |
| 47  | 97,9  | 95,07  | 10          |
| 48  | 99,9  | 97,09  | 10          |
| 49  | 101,9 | 99,10  | 10          |
| 50  | 103,9 | 101,13 | 10          |
| 51  | 105,9 | 103,14 | 12          |
| 52  | 108,0 | 105,16 | 12          |
| 53  | 110,0 | 107,18 | 12          |
| 54  | 112,0 | 109,18 | 12          |
| 55  | 114,0 | 111,23 | 12          |
| 56  | 116,0 | 113,25 | 12          |
| 57  | 118,1 | 115,27 | 12          |
| 58  | 120,1 | 117,29 | 12          |
| 59  | 122,1 | 119,31 | 12          |
| 60  | 124,1 | 121,32 | 12          |
| 62  | 128,2 | 125,37 | 12          |
| 64  | 132,2 | 129,41 | 12          |
| 65  | 134,2 | 131,43 | 12          |
| 66  | 136,2 | 133,45 | 14          |
| 68  | 140,3 | 137,49 | 14          |
| 70  | 144,3 | 141,53 | 14          |
| 72  | 148,4 | 145,58 | 14          |
| 75  | 154,4 | 151,63 | 14          |
| 76  | 156,5 | 153,66 | 14          |
| 78  | 160,5 | 157,70 | 16          |
| 80  | 164,5 | 161,74 | 16          |
| 85  | 174,6 | 171,85 | 16          |
| 90  | 184,7 | 181,95 | 16          |
| 95  | 194,8 | 192,05 | 16          |
| 100 | 204,9 | 202,15 | 16          |
| 110 | 225,1 | 222,37 | 16          |
| 114 | 233,2 | 230,45 | 16          |
| 120 | 245,4 | 242,58 | 16          |
| 125 | 255,5 | 252,68 | 16          |

# KOŁA ŁAŃCUCHOWE TARCZOWE

8 x 3,0 mm 05B-1-2

## ŁAŃCUCH

|        | Podziałka | Szerokość wew. | Rolka Ø |
|--------|-----------|----------------|---------|
| ISO mm | 8         | 3              | 5       |

## KOŁO ŁAŃCUCHOWE

|        | r   | C   | h <sub>1</sub> | L   | h <sub>2</sub> | h <sub>3</sub> | H |
|--------|-----|-----|----------------|-----|----------------|----------------|---|
| ISO mm | 8,0 | 1,0 | 2,8            | 2,7 | 8,3            | -              | - |

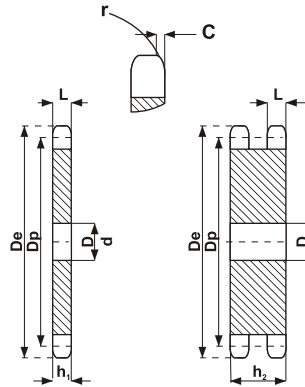

Mat. Stal C45 E UNI EN1083-1

ISO R606/ DIN 8187

| Z  | De    | Dp     | 1 - rzędowe | 2 - rzędowe |
|----|-------|--------|-------------|-------------|
|    |       |        | D           | D           |
| 8  | 24,0  | 20,90  | 6           | 6           |
| 9  | 26,6  | 23,39  | 6           | 6           |
| 10 | 29,2  | 25,89  | 8           | 8           |
| 11 | 31,7  | 28,39  | 8           | 8           |
| 12 | 34,2  | 30,91  | 8           | 8           |
| 13 | 36,7  | 33,42  | 8           | 8           |
| 14 | 39,2  | 35,95  | 8           | 8           |
| 15 | 41,7  | 38,48  | 8           | 8           |
| 16 | 44,3  | 41,01  | 8           | 10          |
| 17 | 46,8  | 43,53  | 8           | 10          |
| 18 | 49,3  | 46,07  | 8           | 10          |
| 19 | 51,9  | 48,61  | 8           | 10          |
| 20 | 54,4  | 51,14  | 8           | 10          |
| 21 | 57,0  | 53,67  | 8           | 10          |
| 22 | 59,5  | 56,21  | 8           | 10          |
| 23 | 62,0  | 58,75  | 8           | 10          |
| 24 | 64,6  | 61,29  | 8           | 10          |
| 25 | 67,5  | 63,83  | 8           | 10          |
| 26 | 69,5  | 66,37  | 10          | 12          |
| 27 | 72,2  | 68,91  | 10          | 12          |
| 28 | 74,8  | 71,45  | 10          | 12          |
| 29 | 77,3  | 73,99  | 10          | 12          |
| 30 | 79,8  | 76,53  | 10          | 12          |
| 31 | 82,4  | 79,08  | 10          | 12          |
| 32 | 84,9  | 81,61  | 10          | 12          |
| 33 | 87,5  | 84,16  | 10          | 12          |
| 34 | 90,0  | 86,70  | 10          | 12          |
| 35 | 92,5  | 89,24  | 10          | 12          |
| 36 | 95,0  | 91,79  | 10          | 12          |
| 37 | 97,6  | 94,33  | 10          | 12          |
| 38 | 100,2 | 96,88  | 10          | 12          |
| 39 | 102,7 | 99,42  | 10          | 12          |
| 40 | 105,2 | 101,97 | 10          | 12          |
| 41 | 107,8 | 104,51 | 12          | 14          |
| 42 | 110,4 | 107,05 | 12          | 14          |
| 43 | 112,9 | 109,60 | 12          | 14          |

| Z   | De    | Dp     | 1 - rzędowe | 2 - rzędowe |
|-----|-------|--------|-------------|-------------|
|     |       |        | D           | D           |
| 44  | 115,5 | 112,14 | 12          | 14          |
| 45  | 118,0 | 114,69 | 12          | 14          |
| 46  | 120,6 | 117,23 | 12          | 14          |
| 47  | 123,1 | 119,77 | 12          | 14          |
| 48  | 125,6 | 122,32 | 12          | 14          |
| 49  | 128,2 | 124,86 | 12          | 14          |
| 50  | 130,7 | 127,41 | 12          | 14          |
| 51  | 133,3 | 129,95 | 14          | 16          |
| 52  | 135,8 | 132,49 | 14          | 16          |
| 53  | 138,4 | 135,04 | 14          | 16          |
| 54  | 140,9 | 137,59 | 14          | 16          |
| 55  | 143,5 | 140,13 | 14          | 16          |
| 56  | 146,0 | 142,68 | 14          | 16          |
| 57  | 148,6 | 145,22 | 14          | 16          |
| 58  | 151,0 | 147,77 | 14          | 16          |
| 59  | 153,6 | 150,31 | 14          | 16          |
| 60  | 156,2 | 152,85 | 14          | 16          |
| 62  | 162,0 | 157,95 | 16          | 20          |
| 64  | 167,1 | 163,04 | 16          | 20          |
| 65  | 169,2 | 165,58 | 16          | 20          |
| 66  | 172,2 | 168,13 | 16          | 20          |
| 68  | 177,3 | 173,22 | 16          | 20          |
| 70  | 182,4 | 178,31 | 16          | 20          |
| 72  | 187,5 | 183,41 | 20          | 20          |
| 75  | 195,1 | 191,04 | 20          | 20          |
| 76  | 197,7 | 193,59 | 20          | 20          |
| 78  | 202,8 | 198,68 | 20          | 20          |
| 80  | 207,9 | 203,77 | 20          | 20          |
| 85  | 220,6 | 216,50 | 20          | 20          |
| 90  | 233,4 | 229,23 | 20          | 20          |
| 95  | 246,1 | 241,96 | 20          | 20          |
| 100 | 258,9 | 254,68 | 20          | 20          |
| 110 | 284,3 | 280,15 | 20          | 20          |
| 114 | 294,5 | 290,33 | 20          | 20          |
| 120 | 310,0 | 305,61 | 20          | 20          |
| 125 | 322,5 | 318,34 | 20          | 20          |

# KOŁA ŁAŃCUCHOWE TARCZOWE

3/8" x 7/32" 06B-1-2-3 9,525 x 5,72 mm

## ŁAŃCUCH

|        | Podziałka | Szerokość wew. | Rolka Ø |
|--------|-----------|----------------|---------|
| ISO mm | 9,525     | 5,720          | 6,350   |

## KOŁO ŁAŃCUCHOWE

|        | r    | C   | h <sub>1</sub> | L   | h <sub>2</sub> | h <sub>3</sub> | H |
|--------|------|-----|----------------|-----|----------------|----------------|---|
| ISO mm | 10,0 | 1,6 | 5,3            | 5,2 | 25,6           | -              | - |

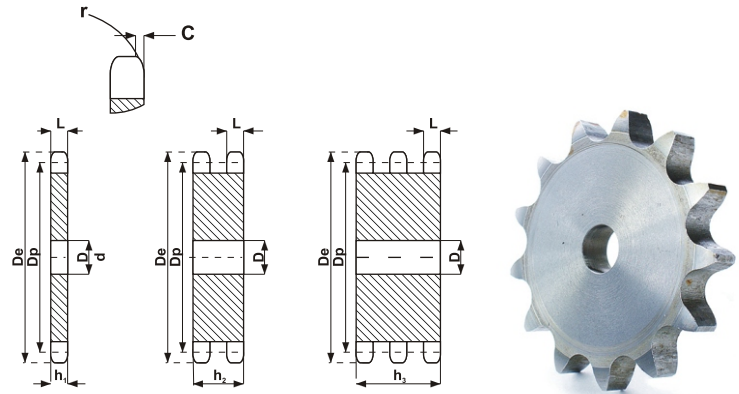

Mat. Stal C45 E UNI EN1083-1

ISO R606/ DIN 8187

| Z  | De    | Dp     | 1 - rzędowe | 2 - rzędowe | 3 - rzędowe |
|----|-------|--------|-------------|-------------|-------------|
|    |       |        | D           | D           | D           |
| 8  | 28,0  | 24,89  | 6           | 6           | 6           |
| 9  | 31,0  | 27,85  | 7           | 8           | 8           |
| 10 | 34,0  | 30,82  | 7           | 8           | 10          |
| 11 | 37,0  | 33,80  | 8           | 10          | 10          |
| 12 | 40,0  | 36,80  | 8           | 10          | 10          |
| 13 | 43,0  | 39,80  | 8           | 10          | 10          |
| 14 | 46,3  | 42,80  | 8           | 10          | 12          |
| 15 | 49,3  | 45,81  | 8           | 10          | 12          |
| 16 | 52,3  | 48,82  | 10          | 12          | 12          |
| 17 | 55,3  | 51,83  | 10          | 12          | 12          |
| 18 | 58,3  | 54,85  | 10          | 12          | 12          |
| 19 | 61,3  | 56,87  | 10          | 12          | 12          |
| 20 | 64,3  | 60,89  | 10          | 12          | 12          |
| 21 | 68,0  | 63,91  | 10          | 12          | 14          |
| 22 | 71,0  | 66,93  | 10          | 12          | 14          |
| 23 | 73,5  | 69,95  | 10          | 12          | 14          |
| 24 | 77,0  | 72,97  | 10          | 12          | 14          |
| 25 | 80,0  | 76,00  | 10          | 12          | 14          |
| 26 | 83,0  | 79,02  | 10          | 12          | 14          |
| 27 | 86,0  | 82,04  | 10          | 12          | 14          |
| 28 | 89,0  | 85,07  | 10          | 12          | 14          |
| 29 | 92,0  | 88,09  | 10          | 12          | 14          |
| 30 | 94,7  | 91,12  | 10          | 12          | 14          |
| 31 | 98,3  | 94,15  | 12          | 14          | 16          |
| 32 | 101,3 | 97,17  | 12          | 14          | 16          |
| 33 | 104,3 | 100,20 | 12          | 14          | 16          |
| 34 | 107,3 | 103,23 | 12          | 14          | 16          |
| 35 | 110,4 | 106,26 | 12          | 14          | 16          |
| 36 | 113,4 | 109,29 | 12          | 14          | 16          |
| 37 | 116,4 | 112,32 | 12          | 14          | 16          |
| 38 | 119,5 | 115,34 | 12          | 14          | 16          |
| 39 | 122,5 | 118,37 | 12          | 14          | 16          |
| 40 | 125,5 | 121,40 | 12          | 14          | 16          |
| 41 | 128,5 | 124,43 | 16          | 16          | 16          |
| 42 | 131,6 | 127,46 | 16          | 16          | 16          |
| 43 | 134,6 | 130,49 | 16          | 16          | 16          |

| Z   | De    | Dp     | 1 - rzędowe | 2 - rzędowe | 3 - rzędowe |
|-----|-------|--------|-------------|-------------|-------------|
|     |       |        | D           | D           | D           |
| 44  | 137,6 | 133,52 | 16          | 16          | 16          |
| 45  | 140,7 | 136,54 | 16          | 16          | 16          |
| 46  | 143,7 | 139,58 | 16          | 16          | 16          |
| 47  | 146,7 | 142,61 | 16          | 16          | 16          |
| 48  | 149,7 | 145,64 | 16          | 16          | 16          |
| 49  | 152,7 | 148,66 | 16          | 16          | 16          |
| 50  | 155,7 | 151,69 | 16          | 16          | 16          |
| 51  | 158,7 | 154,72 | 16          | 16          | 20          |
| 52  | 161,8 | 157,75 | 16          | 16          | 20          |
| 53  | 164,8 | 160,78 | 16          | 16          | 20          |
| 54  | 167,8 | 163,82 | 16          | 16          | 20          |
| 55  | 170,8 | 166,85 | 16          | 16          | 20          |
| 56  | 173,8 | 169,88 | 16          | 16          | 20          |
| 57  | 176,9 | 172,91 | 16          | 16          | 20          |
| 58  | 179,9 | 175,93 | 16          | 16          | 20          |
| 59  | 183,0 | 178,96 | 16          | 16          | 20          |
| 60  | 186,0 | 181,99 | 16          | 16          | 20          |
| 62  | 192,1 | 188,06 | 20          | 20          | 20          |
| 64  | 198,2 | 194,12 | 20          | 20          | 20          |
| 65  | 201,6 | 197,15 | 20          | 20          | 20          |
| 66  | 204,6 | 200,18 | 20          | 20          | 25          |
| 68  | 210,7 | 206,24 | 20          | 20          | 25          |
| 70  | 216,7 | 212,30 | 20          | 20          | 25          |
| 72  | 222,8 | 218,37 | 20          | 20          | 25          |
| 75  | 231,9 | 227,46 | 20          | 20          | 25          |
| 76  | 234,9 | 230,49 | 20          | 20          | 25          |
| 78  | 241,0 | 236,55 | 20          | 20          | 25          |
| 80  | 247,1 | 242,61 | 20          | 20          | 25          |
| 85  | 262,2 | 257,77 | 20          | 20          | 25          |
| 90  | 277,4 | 272,93 | 20          | 20          | 25          |
| 95  | 292,5 | 288,08 | 20          | 20          | 25          |
| 100 | 307,7 | 303,25 | 20          | 20          | 25          |
| 110 | 338,0 | 333,55 | 20          | 20          | 25          |
| 114 | 349,5 | 345,68 | 20          | 20          | 25          |
| 120 | 368,3 | 363,86 | 20          | 20          | 25          |
| 125 | 383,5 | 379,02 | 20          | 20          | 25          |

1/2" x 1/8" 081-1 12,7 x 3,33 mm

## ŁAŃCUCH

|        | Podziałka | Szerokość wew. | Rolka Ø |
|--------|-----------|----------------|---------|
| ISO mm | 12,70     | 3,30           | 7,75    |

## KOŁO ŁAŃCUCHOWE

|        | r    | C   | h <sub>1</sub> | L | h <sub>2</sub> | h <sub>3</sub> | H |
|--------|------|-----|----------------|---|----------------|----------------|---|
| ISO mm | 13,0 | 1,3 | 3,8            | - | -              | -              | - |

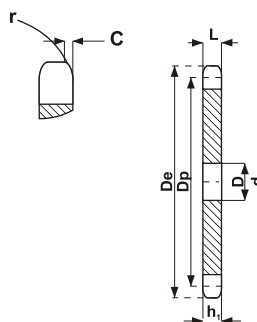

Mat. Stal C45 E UNI EN1083-1

ISO R606/ DIN 8187

| Z  | De    | Dp     | 1 - rzędowe |
|----|-------|--------|-------------|
|    |       |        | D           |
| 8  | 37,2  | 33,18  | 8           |
| 9  | 41,5  | 37,13  | 8           |
| 10 | 46,2  | 41,10  | 8           |
| 11 | 49,6  | 45,07  | 8           |
| 12 | 53,9  | 49,07  | 8           |
| 13 | 58,4  | 53,06  | 8           |
| 14 | 62,8  | 57,07  | 8           |
| 15 | 66,8  | 61,09  | 8           |
| 16 | 70,9  | 65,10  | 10          |
| 17 | 74,9  | 69,11  | 10          |
| 18 | 78,9  | 73,14  | 10          |
| 19 | 82,9  | 77,16  | 10          |
| 20 | 86,9  | 81,19  | 10          |
| 21 | 91,0  | 85,22  | 10          |
| 22 | 95,0  | 89,24  | 10          |
| 23 | 99,0  | 93,27  | 10          |
| 24 | 103,0 | 97,29  | 10          |
| 25 | 107,1 | 101,33 | 10          |
| 26 | 111,2 | 105,36 | 12          |
| 27 | 115,4 | 109,40 | 12          |
| 28 | 119,4 | 113,42 | 12          |
| 29 | 123,4 | 117,46 | 12          |
| 30 | 127,5 | 121,50 | 12          |
| 31 | 131,5 | 125,54 | 12          |
| 32 | 135,5 | 129,56 | 12          |
| 33 | 139,6 | 133,60 | 12          |
| 34 | 143,6 | 137,64 | 12          |
| 35 | 147,6 | 141,68 | 12          |
| 36 | 151,7 | 145,72 | 16          |
| 37 | 155,7 | 149,76 | 16          |
| 38 | 159,8 | 153,80 | 16          |
| 39 | 163,8 | 157,83 | 16          |
| 40 | 167,8 | 161,87 | 16          |
| 41 | 171,4 | 165,91 | 16          |
| 42 | 175,4 | 169,95 | 16          |

| Z   | De    | Dp     | 1 - rzędowe |
|-----|-------|--------|-------------|
|     |       |        | D           |
| 43  | 179,5 | 173,99 | 16          |
| 44  | 183,5 | 178,03 | 16          |
| 45  | 187,5 | 182,07 | 16          |
| 46  | 191,6 | 186,10 | 20          |
| 47  | 195,6 | 190,14 | 20          |
| 48  | 199,7 | 194,18 | 20          |
| 49  | 203,7 | 198,22 | 20          |
| 50  | 207,8 | 202,26 | 20          |
| 51  | 211,8 | 206,30 | 20          |
| 52  | 215,9 | 210,34 | 20          |
| 53  | 219,9 | 214,37 | 20          |
| 54  | 224,0 | 218,43 | 20          |
| 55  | 228,0 | 222,46 | 20          |
| 56  | 232,1 | 226,50 | 20          |
| 57  | 236,1 | 230,54 | 20          |
| 58  | 240,2 | 234,58 | 20          |
| 59  | 244,2 | 238,62 | 20          |
| 60  | 248,2 | 242,66 | 20          |
| 62  | 256,7 | 250,75 | 20          |
| 64  | 264,8 | 258,82 | 20          |
| 65  | 268,8 | 262,86 | 20          |
| 66  | 272,9 | 266,90 | 25          |
| 68  | 280,9 | 274,99 | 25          |
| 70  | 289,0 | 283,07 | 25          |
| 72  | 297,1 | 291,16 | 25          |
| 76  | 313,3 | 307,33 | 25          |
| 78  | 321,4 | 315,40 | 25          |
| 80  | 329,4 | 323,48 | 25          |
| 85  | 349,7 | 343,70 | 25          |
| 90  | 369,9 | 363,90 | 25          |
| 100 | 410,3 | 404,31 | 25          |
| 110 | 450,7 | 444,74 | 25          |
| 114 | 466,9 | 460,90 | 25          |
| 120 | 491,2 | 485,16 | 25          |
| 125 | 511,4 | 505,37 | 25          |

1/2" x 3/16" 083-1/084-1 12,7 x 4,88 mm

## ŁAŃCUCH

|        | Podziałka | Szerokość wew. | Rolka Ø |
|--------|-----------|----------------|---------|
| ISO mm | 12,70     | 4,88           | 7,75    |

## KOŁO ŁAŃCUCHOWE

|        | r    | C   | h <sub>1</sub> | L | h <sub>2</sub> | h <sub>3</sub> | H |
|--------|------|-----|----------------|---|----------------|----------------|---|
| ISO mm | 13,0 | 1,3 | 4,5            | - | -              | -              | - |

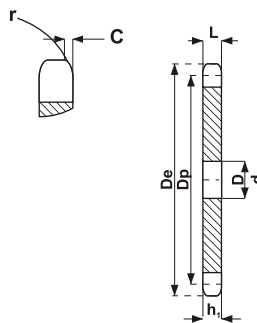

Mat. Stal C45 E UNI EN1083-1

ISO R606/ DIN 8187

| Z  | De    | Dp     | 1 - rzędowe |
|----|-------|--------|-------------|
|    |       |        | D           |
| 8  | 38,5  | 33,18  | 8           |
| 9  | 41,5  | 37,13  | 8           |
| 10 | 46,2  | 41,10  | 8           |
| 11 | 49,6  | 45,07  | 8           |
| 12 | 53,9  | 49,07  | 8           |
| 13 | 58,4  | 53,06  | 8           |
| 14 | 62,8  | 57,07  | 8           |
| 15 | 66,8  | 61,09  | 8           |
| 16 | 70,9  | 65,10  | 10          |
| 17 | 74,9  | 69,11  | 10          |
| 18 | 78,9  | 73,14  | 10          |
| 19 | 82,9  | 77,16  | 10          |
| 20 | 86,9  | 81,19  | 10          |
| 21 | 91,0  | 85,22  | 10          |
| 22 | 95,0  | 89,24  | 10          |
| 23 | 99,0  | 93,27  | 10          |
| 24 | 103,0 | 97,29  | 10          |
| 25 | 107,1 | 101,33 | 10          |
| 26 | 111,2 | 105,36 | 12          |
| 27 | 115,4 | 109,40 | 12          |
| 28 | 119,4 | 113,42 | 12          |
| 29 | 123,4 | 117,46 | 12          |
| 30 | 127,5 | 121,50 | 12          |
| 31 | 131,5 | 125,54 | 12          |
| 32 | 135,5 | 129,56 | 12          |
| 33 | 139,6 | 133,60 | 12          |
| 34 | 143,6 | 137,64 | 12          |
| 35 | 147,6 | 141,68 | 12          |
| 36 | 151,7 | 145,72 | 16          |
| 37 | 155,7 | 149,76 | 16          |
| 38 | 159,8 | 153,80 | 16          |
| 39 | 163,8 | 157,83 | 16          |
| 40 | 167,8 | 161,87 | 16          |
| 41 | 171,4 | 165,91 | 16          |
| 42 | 175,4 | 169,95 | 16          |

| Z   | De    | Dp     | 1 - rzędowe |
|-----|-------|--------|-------------|
|     |       |        | D           |
| 43  | 179,5 | 173,99 | 16          |
| 44  | 183,5 | 178,03 | 16          |
| 45  | 187,5 | 182,07 | 16          |
| 46  | 191,6 | 186,10 | 20          |
| 47  | 195,6 | 190,14 | 20          |
| 48  | 199,7 | 194,18 | 20          |
| 49  | 203,7 | 198,22 | 20          |
| 50  | 207,8 | 202,26 | 20          |
| 51  | 211,8 | 206,30 | 20          |
| 52  | 215,9 | 210,34 | 20          |
| 53  | 219,9 | 214,37 | 20          |
| 54  | 224,0 | 218,43 | 20          |
| 55  | 228,0 | 222,46 | 20          |
| 56  | 232,1 | 226,50 | 20          |
| 57  | 236,1 | 230,54 | 20          |
| 58  | 240,2 | 234,58 | 20          |
| 59  | 244,2 | 238,62 | 20          |
| 60  | 248,2 | 242,66 | 20          |
| 62  | 256,7 | 250,75 | 20          |
| 64  | 264,8 | 258,82 | 20          |
| 65  | 268,8 | 262,86 | 20          |
| 66  | 272,9 | 266,90 | 25          |
| 68  | 280,9 | 274,99 | 25          |
| 70  | 289,0 | 283,07 | 25          |
| 72  | 297,1 | 291,16 | 25          |
| 76  | 313,3 | 307,33 | 25          |
| 78  | 321,4 | 315,40 | 25          |
| 80  | 329,4 | 323,48 | 25          |
| 85  | 349,7 | 343,70 | 25          |
| 90  | 369,9 | 363,90 | 25          |
| 100 | 410,3 | 404,31 | 25          |
| 110 | 450,7 | 444,74 | 25          |
| 114 | 466,9 | 460,90 | 25          |
| 120 | 491,2 | 485,16 | 25          |
| 125 | 511,4 | 505,37 | 25          |

1/2" x 1/4" 085-1 12,7 x 6,4 x 7,75 mm

## ŁAŃCUCH

|        | Podziałka | Szerokość wew. | Rolka Ø |
|--------|-----------|----------------|---------|
| ISO mm | 12,70     | 6,40           | 7,75    |

## KOŁO ŁAŃCUCHOWE

|        | r    | C   | h <sub>1</sub> | L | h <sub>2</sub> | h <sub>3</sub> | H |
|--------|------|-----|----------------|---|----------------|----------------|---|
| ISO mm | 13,0 | 1,3 | 5,9            | - | -              | -              | - |

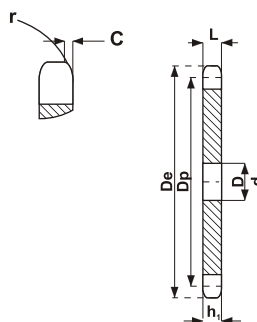

Mat. Stal C45 E UNI EN1083-1

ISO R606/ DIN 8187

| Z  | De    | Dp     | 1 - rzędowe |
|----|-------|--------|-------------|
|    |       |        | D           |
| 8  | 38,5  | 33,18  | 8           |
| 9  | 41,5  | 37,13  | 8           |
| 10 | 46,2  | 41,10  | 8           |
| 11 | 49,6  | 45,07  | 8           |
| 12 | 53,9  | 49,07  | 8           |
| 13 | 58,4  | 53,06  | 8           |
| 14 | 62,8  | 57,07  | 8           |
| 15 | 66,8  | 61,09  | 8           |
| 16 | 70,9  | 65,10  | 10          |
| 17 | 74,9  | 69,11  | 10          |
| 18 | 78,9  | 73,14  | 10          |
| 19 | 82,9  | 77,16  | 10          |
| 20 | 86,9  | 81,19  | 10          |
| 21 | 91,0  | 85,22  | 10          |
| 22 | 95,0  | 89,24  | 10          |
| 23 | 99,0  | 93,27  | 10          |
| 24 | 103,0 | 97,29  | 10          |
| 25 | 107,1 | 101,33 | 10          |
| 26 | 111,2 | 105,36 | 12          |
| 27 | 115,4 | 109,40 | 12          |
| 28 | 119,4 | 113,42 | 12          |
| 29 | 123,4 | 117,46 | 12          |
| 30 | 127,5 | 121,50 | 12          |
| 31 | 131,5 | 125,54 | 12          |
| 32 | 135,5 | 129,56 | 12          |
| 33 | 139,6 | 133,60 | 12          |
| 34 | 143,6 | 137,64 | 12          |
| 35 | 147,6 | 141,68 | 12          |
| 36 | 151,7 | 145,72 | 16          |
| 37 | 155,7 | 149,76 | 16          |
| 38 | 159,8 | 153,80 | 16          |
| 39 | 163,8 | 157,83 | 16          |
| 40 | 167,8 | 161,87 | 16          |
| 41 | 171,4 | 165,91 | 16          |
| 42 | 175,4 | 169,95 | 16          |

| Z   | De    | Dp     | 1 - rzędowe |
|-----|-------|--------|-------------|
|     |       |        | D           |
| 43  | 179,5 | 173,99 | 16          |
| 44  | 183,5 | 178,03 | 16          |
| 45  | 187,5 | 182,07 | 16          |
| 46  | 191,6 | 186,10 | 20          |
| 47  | 195,6 | 190,14 | 20          |
| 48  | 199,7 | 194,18 | 20          |
| 49  | 203,7 | 198,22 | 20          |
| 50  | 207,8 | 202,26 | 20          |
| 51  | 211,8 | 206,30 | 20          |
| 52  | 215,9 | 210,34 | 20          |
| 53  | 219,9 | 214,37 | 20          |
| 54  | 224,0 | 218,43 | 20          |
| 55  | 228,0 | 222,46 | 20          |
| 56  | 232,1 | 226,50 | 20          |
| 57  | 236,1 | 230,54 | 20          |
| 58  | 240,2 | 234,58 | 20          |
| 59  | 244,2 | 238,62 | 20          |
| 60  | 248,2 | 242,66 | 20          |
| 62  | 256,7 | 250,75 | 20          |
| 64  | 264,8 | 258,82 | 20          |
| 65  | 268,8 | 262,86 | 20          |
| 66  | 272,9 | 266,90 | 25          |
| 68  | 280,9 | 274,99 | 25          |
| 70  | 289,0 | 283,07 | 25          |
| 72  | 297,1 | 291,16 | 25          |
| 76  | 313,3 | 307,33 | 25          |
| 78  | 321,4 | 315,40 | 25          |
| 80  | 329,4 | 323,48 | 25          |
| 85  | 349,7 | 343,70 | 25          |
| 90  | 369,9 | 363,90 | 25          |
| 100 | 410,3 | 404,31 | 25          |
| 110 | 450,7 | 444,74 | 25          |
| 114 | 466,9 | 460,90 | 25          |
| 120 | 491,2 | 485,16 | 25          |
| 125 | 511,4 | 505,37 | 25          |



# KOŁA ŁAŃCUCHOWE TARCZOWE

1/2" x 1/4" 085-1 12,7 x 6,4 x 8,51 mm

## ŁAŃCUCH

|        | Podziałka | Szerokość wew. | Rolka Ø |
|--------|-----------|----------------|---------|
| ISO mm | 12,70     | 6,40           | 8,51    |

## KOŁO ŁAŃCUCHOWE

|        | r    | C   | h <sub>1</sub> | L | h <sub>2</sub> | h <sub>3</sub> | H |
|--------|------|-----|----------------|---|----------------|----------------|---|
| ISO mm | 13,0 | 1,3 | 5,9            | - | -              | -              | - |

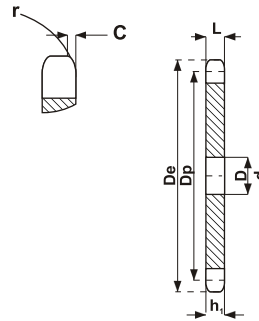

Mat. Stal C45 E UNI EN1083-1

ISO R606/ DIN 8187

| Z  | De    | Dp     | 1 - rzędowe |
|----|-------|--------|-------------|
|    |       |        | D           |
| 8  | 37,2  | 33,18  | 8           |
| 9  | 41,0  | 37,13  | 8           |
| 10 | 45,2  | 41,10  | 8           |
| 11 | 48,7  | 45,07  | 8           |
| 12 | 53,0  | 49,07  | 8           |
| 13 | 57,4  | 53,06  | 8           |
| 14 | 61,8  | 57,07  | 8           |
| 15 | 65,5  | 61,09  | 8           |
| 16 | 69,5  | 65,10  | 10          |
| 17 | 73,6  | 69,11  | 10          |
| 18 | 77,8  | 73,14  | 10          |
| 19 | 81,7  | 77,16  | 10          |
| 20 | 85,8  | 81,19  | 10          |
| 21 | 89,7  | 85,22  | 10          |
| 22 | 93,8  | 89,24  | 10          |
| 23 | 98,2  | 93,27  | 10          |
| 24 | 101,8 | 97,29  | 10          |
| 25 | 105,8 | 101,33 | 10          |
| 26 | 110,0 | 105,36 | 12          |
| 27 | 114,0 | 109,40 | 12          |
| 28 | 118,0 | 113,42 | 12          |
| 29 | 122,0 | 117,46 | 12          |
| 30 | 126,1 | 121,50 | 12          |
| 31 | 130,2 | 125,54 | 12          |
| 32 | 134,2 | 129,56 | 12          |
| 33 | 138,4 | 133,60 | 12          |
| 34 | 142,6 | 137,64 | 12          |
| 35 | 146,7 | 141,68 | 12          |
| 36 | 151,0 | 145,72 | 16          |
| 37 | 154,6 | 149,76 | 16          |
| 38 | 158,6 | 153,80 | 16          |
| 39 | 162,7 | 157,83 | 16          |
| 40 | 166,8 | 161,87 | 16          |
| 41 | 171,4 | 165,91 | 16          |
| 42 | 175,4 | 169,95 | 16          |

| Z   | De    | Dp     | 1 - rzędowe |
|-----|-------|--------|-------------|
|     |       |        | D           |
| 43  | 179,7 | 173,99 | 16          |
| 44  | 183,5 | 178,03 | 16          |
| 45  | 188,0 | 182,07 | 16          |
| 46  | 192,1 | 186,10 | 20          |
| 47  | 196,2 | 190,14 | 20          |
| 48  | 200,3 | 194,18 | 20          |
| 49  | 204,3 | 198,22 | 20          |
| 50  | 208,3 | 202,26 | 20          |
| 51  | 212,1 | 206,30 | 20          |
| 52  | 216,1 | 210,34 | 20          |
| 53  | 220,2 | 214,37 | 20          |
| 54  | 224,1 | 218,43 | 20          |
| 55  | 228,1 | 222,46 | 20          |
| 56  | 232,2 | 226,50 | 20          |
| 57  | 236,4 | 230,54 | 20          |
| 58  | 240,5 | 234,58 | 20          |
| 59  | 244,5 | 238,62 | 20          |
| 60  | 248,6 | 242,66 | 20          |
| 62  | 256,9 | 250,75 | 20          |
| 64  | 265,1 | 258,82 | 20          |
| 65  | 269,0 | 262,86 | 20          |
| 66  | 273,0 | 266,90 | 25          |
| 68  | 281,0 | 274,99 | 25          |
| 70  | 289,0 | 283,07 | 25          |
| 72  | 297,2 | 291,16 | 25          |
| 76  | 313,3 | 307,33 | 25          |
| 78  | 321,4 | 315,40 | 25          |
| 80  | 329,4 | 323,48 | 25          |
| 85  | 349,0 | 343,70 | 25          |
| 90  | 369,9 | 363,90 | 25          |
| 100 | 410,3 | 404,31 | 25          |
| 110 | 450,7 | 444,74 | 25          |
| 114 | 466,9 | 460,90 | 25          |
| 120 | 491,2 | 485,16 | 25          |
| 125 | 511,3 | 505,37 | 25          |

# KOŁA ŁAŃCUCHOWE TARCZOWE

1/2" x 5/16" 08B-1-2-3 12,7 x 7,75 mm

## ŁAŃCUCH

|        | Podziałka | Szerokość wew. | Rolka Ø |
|--------|-----------|----------------|---------|
| ISO mm | 12,70     | 7,75           | 8,51    |

## KOŁO ŁAŃCUCHOWE

|        | r    | C   | h <sub>1</sub> | L   | h <sub>2</sub> | h <sub>3</sub> | H |
|--------|------|-----|----------------|-----|----------------|----------------|---|
| ISO mm | 13,0 | 1,3 | 7,2            | 7,0 | 21,0           | 34,9           | - |

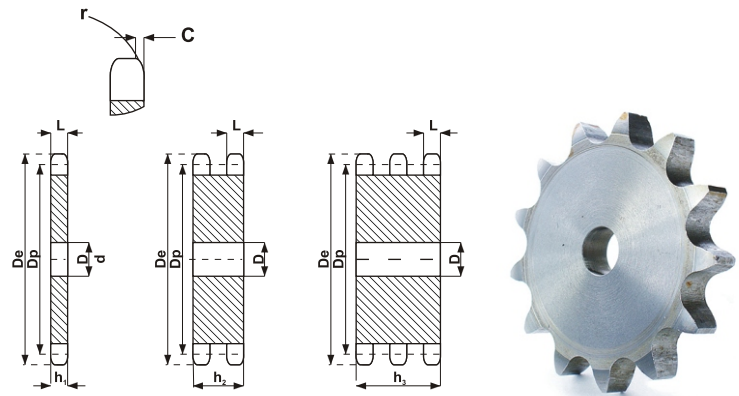

Mat. Stal C45 E UNI EN1083-1

ISO R606/ DIN 8187

| Z  | De    | Dp     | 1 - rzędowe | 2 - rzędowe | 3 - rzędowe |
|----|-------|--------|-------------|-------------|-------------|
|    |       |        | D           | D           | D           |
| 8  | 37,2  | 33,18  | 8           | 10          | 10          |
| 9  | 41,0  | 37,13  | 8           | 10          | 10          |
| 10 | 45,2  | 41,10  | 8           | 10          | 10          |
| 11 | 48,7  | 45,07  | 10          | 10          | 12          |
| 12 | 53,0  | 49,07  | 10          | 10          | 12          |
| 13 | 57,4  | 53,06  | 10          | 10          | 12          |
| 14 | 61,8  | 57,07  | 10          | 10          | 12          |
| 15 | 65,5  | 61,09  | 10          | 10          | 12          |
| 16 | 69,5  | 65,10  | 10          | 12          | 16          |
| 17 | 73,6  | 69,11  | 10          | 12          | 16          |
| 18 | 77,8  | 73,14  | 10          | 12          | 16          |
| 19 | 81,7  | 77,16  | 10          | 12          | 16          |
| 20 | 85,8  | 81,19  | 10          | 12          | 16          |
| 21 | 89,7  | 85,22  | 12          | 16          | 16          |
| 22 | 93,8  | 89,24  | 12          | 16          | 16          |
| 23 | 98,2  | 93,27  | 12          | 16          | 16          |
| 24 | 101,8 | 97,29  | 12          | 16          | 16          |
| 25 | 105,8 | 101,33 | 12          | 16          | 16          |
| 26 | 110,0 | 105,36 | 16          | 16          | 16          |
| 27 | 114,0 | 109,40 | 16          | 16          | 16          |
| 28 | 118,0 | 113,42 | 16          | 16          | 16          |
| 29 | 122,0 | 117,46 | 16          | 16          | 16          |
| 30 | 126,1 | 121,50 | 16          | 16          | 16          |
| 31 | 130,2 | 125,54 | 16          | 16          | 20          |
| 32 | 134,3 | 129,56 | 16          | 16          | 20          |
| 33 | 138,4 | 133,60 | 16          | 16          | 20          |
| 34 | 142,6 | 137,64 | 16          | 16          | 20          |
| 35 | 146,7 | 141,68 | 16          | 16          | 20          |
| 36 | 151,0 | 145,72 | 16          | 20          | 20          |
| 37 | 154,6 | 149,76 | 16          | 20          | 20          |
| 38 | 158,6 | 153,80 | 16          | 20          | 20          |
| 39 | 162,7 | 157,83 | 16          | 20          | 20          |
| 40 | 166,8 | 161,87 | 16          | 20          | 20          |
| 41 | 171,4 | 165,91 | 20          | 20          | 25          |
| 42 | 175,4 | 169,95 | 20          | 20          | 25          |
| 43 | 179,7 | 173,99 | 20          | 20          | 25          |

| Z   | De    | Dp     | 1 - rzędowe | 2 - rzędowe | 3 - rzędowe |
|-----|-------|--------|-------------|-------------|-------------|
|     |       |        | D           | D           | D           |
| 44  | 183,8 | 178,03 | 20          | 20          | 25          |
| 45  | 188,0 | 182,07 | 20          | 20          | 25          |
| 46  | 192,1 | 186,10 | 20          | 20          | 25          |
| 47  | 196,2 | 190,14 | 20          | 20          | 25          |
| 48  | 200,3 | 194,18 | 20          | 20          | 25          |
| 49  | 204,3 | 198,22 | 20          | 20          | 25          |
| 50  | 208,3 | 202,26 | 20          | 20          | 25          |
| 51  | 212,1 | 206,30 | 20          | 25          | 25          |
| 52  | 216,1 | 210,34 | 20          | 25          | 25          |
| 53  | 220,2 | 214,37 | 20          | 25          | 25          |
| 54  | 224,1 | 218,43 | 20          | 25          | 25          |
| 55  | 228,1 | 222,46 | 20          | 25          | 25          |
| 56  | 232,2 | 226,50 | 20          | 25          | 25          |
| 57  | 236,4 | 230,54 | 20          | 25          | 25          |
| 58  | 240,5 | 234,58 | 20          | 25          | 25          |
| 59  | 244,5 | 238,62 | 20          | 25          | 25          |
| 60  | 248,6 | 242,66 | 20          | 25          | 25          |
| 62  | 256,9 | 250,75 | 25          | 25          | 25          |
| 64  | 265,1 | 258,82 | 25          | 25          | 25          |
| 65  | 269,0 | 262,86 | 25          | 25          | 25          |
| 66  | 273,0 | 266,90 | 25          | 25          | 25          |
| 68  | 281,0 | 274,99 | 25          | 25          | 25          |
| 70  | 289,0 | 283,07 | 25          | 25          | 25          |
| 72  | 297,2 | 291,16 | 25          | 25          | 25          |
| 75  | 309,2 | 303,27 | 25          | 25          | 25          |
| 76  | 313,3 | 307,33 | 25          | 25          | 25          |
| 78  | 321,4 | 315,40 | 25          | 25          | 25          |
| 80  | 329,4 | 323,48 | 25          | 25          | 25          |
| 85  | 349,0 | 343,69 | 25          | 25          | 25          |
| 90  | 369,9 | 363,90 | 25          | 25          | 25          |
| 95  | 390,1 | 384,11 | 25          | 25          | 25          |
| 100 | 410,3 | 404,31 | 25          | 25          | 25          |
| 110 | 450,7 | 444,74 | 25          | 25          | 25          |
| 114 | 466,9 | 460,90 | 25          | 25          | 25          |
| 120 | 491,2 | 485,16 | 25          | 25          | 25          |
| 125 | 511,3 | 505,37 | 25          | 25          | 25          |

# KOŁA ŁAŃCUCHOWE TARCZOWE

5/8" x 3/8" 10B-1-2-3 15,875 x 9,65 mm

## ŁAŃCUCH

|        | Podziałka | Szerokość wew. | Rolka Ø |
|--------|-----------|----------------|---------|
| ISO mm | 15,875    | 9,658          | 10,160  |

## KOŁO ŁAŃCUCHOWE

|        | r    | C   | h <sub>1</sub> | L   | h <sub>2</sub> | h <sub>3</sub> | H |
|--------|------|-----|----------------|-----|----------------|----------------|---|
| ISO mm | 16,0 | 1,6 | 9,1            | 9,0 | 25,5           | 42,1           | - |

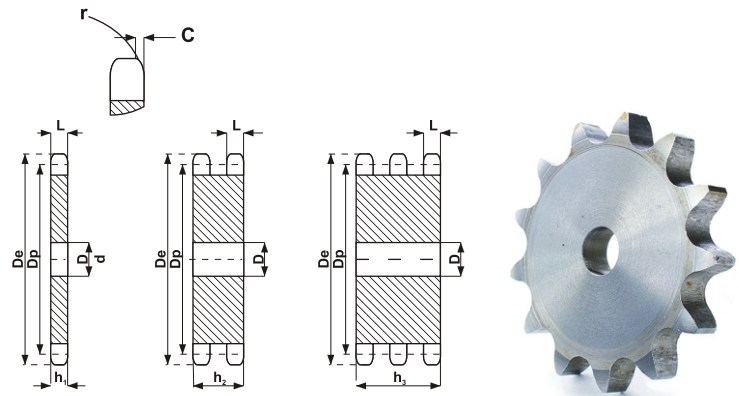

Mat. Stal C45 E UNI EN1083-1

ISO R606/ DIN 8187

| Z  | De     | Dp     | 1 - rzędowe | 2 - rzędowe | 3 - rzędowe |
|----|--------|--------|-------------|-------------|-------------|
|    |        |        | D           | D           | D           |
| 8  | 47,0   | 41,48  | 10          | 10          | 12          |
| 9  | 52,6   | 46,42  | 10          | 10          | 12          |
| 10 | 57,5   | 51,37  | 10          | 10          | 12          |
| 11 | 63,0   | 56,34  | 10          | 12          | 12          |
| 12 | 68,0   | 61,34  | 10          | 12          | 12          |
| 13 | 73,0   | 66,32  | 10          | 12          | 12          |
| 14 | 78,0   | 71,34  | 10          | 12          | 12          |
| 15 | 83,0   | 76,36  | 10          | 12          | 12          |
| 16 | 88,0   | 81,37  | 12          | 12          | 16          |
| 17 | 93,0   | 86,39  | 12          | 12          | 16          |
| 18 | 98,3   | 91,42  | 12          | 12          | 16          |
| 19 | 103,3  | 96,45  | 12          | 12          | 16          |
| 20 | 108,4  | 101,49 | 12          | 12          | 16          |
| 21 | 113,4  | 106,52 | 12          | 16          | 16          |
| 22 | 118,00 | 111,55 | 12          | 16          | 16          |
| 23 | 123,4  | 116,58 | 12          | 16          | 16          |
| 24 | 128,3  | 121,62 | 12          | 16          | 16          |
| 25 | 134,0  | 126,66 | 12          | 16          | 16          |
| 26 | 139,0  | 131,70 | 16          | 16          | 20          |
| 27 | 144,0  | 136,75 | 16          | 16          | 20          |
| 28 | 148,7  | 141,78 | 16          | 16          | 20          |
| 29 | 153,8  | 146,83 | 16          | 16          | 20          |
| 30 | 158,8  | 151,87 | 16          | 16          | 20          |
| 31 | 163,9  | 156,92 | 16          | 20          | 20          |
| 32 | 168,9  | 161,95 | 16          | 20          | 20          |
| 33 | 174,5  | 167,00 | 16          | 20          | 20          |
| 34 | 179,0  | 172,05 | 16          | 20          | 20          |
| 35 | 184,1  | 177,10 | 16          | 20          | 20          |
| 36 | 189,1  | 182,15 | 20          | 20          | 20          |
| 37 | 194,2  | 187,20 | 20          | 20          | 25          |
| 38 | 199,2  | 192,24 | 20          | 20          | 25          |
| 39 | 204,2  | 197,29 | 20          | 20          | 25          |
| 40 | 209,3  | 202,34 | 20          | 20          | 25          |
| 41 | 214,8  | 207,39 | 20          | 20          | 25          |
| 42 | 219,9  | 212,44 | 20          | 20          | 25          |
| 43 | 224,9  | 217,49 | 20          | 20          | 25          |

| Z   | De    | Dp     | 1 - rzędowe | 2 - rzędowe | 3 - rzędowe |
|-----|-------|--------|-------------|-------------|-------------|
|     |       |        | D           | D           | D           |
| 44  | 230,0 | 222,53 | 20          | 20          | 25          |
| 45  | 235,0 | 227,58 | 20          | 20          | 25          |
| 46  | 240,1 | 232,63 | 20          | 25          | 25          |
| 47  | 245,1 | 237,68 | 20          | 25          | 25          |
| 48  | 250,2 | 242,73 | 20          | 25          | 25          |
| 49  | 255,2 | 247,78 | 20          | 25          | 25          |
| 50  | 260,3 | 252,82 | 20          | 25          | 25          |
| 51  | 265,3 | 257,87 | 20          | 25          | 25          |
| 52  | 270,4 | 262,92 | 20          | 25          | 25          |
| 53  | 275,4 | 267,97 | 20          | 25          | 25          |
| 54  | 280,5 | 273,03 | 20          | 25          | 25          |
| 55  | 285,5 | 278,08 | 20          | 25          | 25          |
| 56  | 290,6 | 283,13 | 25          | 25          | 25          |
| 57  | 296,0 | 288,18 | 25          | 25          | 25          |
| 58  | 300,7 | 293,23 | 25          | 25          | 25          |
| 59  | 305,7 | 298,27 | 25          | 25          | 25          |
| 60  | 310,8 | 303,32 | 25          | 25          | 25          |
| 62  | 321,4 | 313,43 | 25          | 25          | 30          |
| 64  | 331,5 | 323,53 | 25          | 25          | 30          |
| 65  | 336,5 | 328,58 | 25          | 25          | 30          |
| 66  | 341,6 | 333,63 | 25          | 25          | 30          |
| 68  | 351,7 | 343,74 | 25          | 25          | 30          |
| 70  | 361,8 | 353,84 | 25          | 25          | 30          |
| 72  | 371,9 | 363,95 | 25          | 25          | 30          |
| 75  | 387,1 | 379,09 | 25          | 25          | 30          |
| 76  | 392,1 | 384,16 | 25          | 25          | 30          |
| 78  | 402,2 | 394,25 | 25          | 25          | 30          |
| 80  | 412,3 | 404,35 | 25          | 25          | 30          |
| 85  | 437,6 | 429,62 | 30          | 30          | 30          |
| 90  | 462,8 | 454,88 | 30          | 30          | 30          |
| 95  | 488,5 | 480,14 | 30          | 30          | 30          |
| 100 | 513,4 | 505,40 | 30          | 30          | 30          |
| 110 | 563,9 | 555,92 | 30          | 30          | 30          |
| 114 | 584,1 | 576,13 | 30          | 30          | 30          |
| 120 | 614,8 | 606,44 | 30          | 30          | 30          |
| 125 | 639,7 | 631,74 | 30          | 30          | 30          |

# KOŁA ŁAŃCUCHOWE TARCZOWE

3/4" x 7/16" 12B-1-2-3 19,05 x 11,68 mm

## ŁAŃCUCH

|        | Podziałka | Szerokość wew. | Rolka Ø |
|--------|-----------|----------------|---------|
| ISO mm | 19,05     | 11,68          | 12,07   |

## KOŁO ŁAŃCUCHOWE

|        | r    | C   | h <sub>1</sub> | L    | h <sub>2</sub> | h <sub>3</sub> | H |
|--------|------|-----|----------------|------|----------------|----------------|---|
| ISO mm | 19,0 | 2,3 | 11,1           | 10,8 | 30,3           | 49,8           | - |

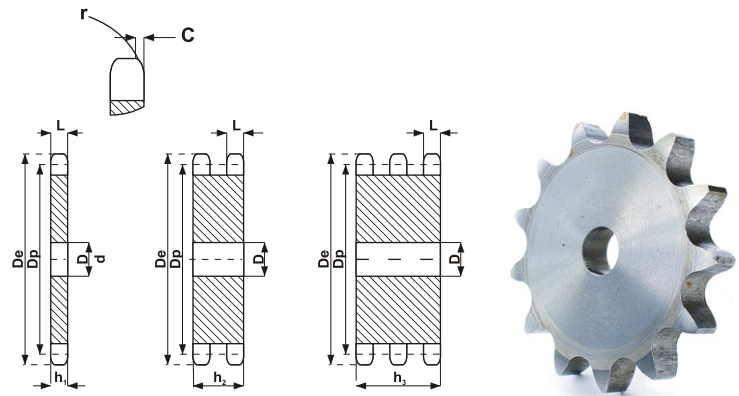

Mat. Stal C45 E UNI EN1083-1

ISO R606/ DIN 8187

| Z  | De    | Dp     | 1 - rzędowe | 2 - rzędowe | 3 - rzędowe |
|----|-------|--------|-------------|-------------|-------------|
|    |       |        | D           | D           | D           |
| 8  | 57,6  | 49,78  | 12          | 12          | 12          |
| 9  | 62,0  | 55,70  | 12          | 12          | 12          |
| 10 | 69,0  | 61,64  | 12          | 12          | 12          |
| 11 | 75,0  | 67,61  | 14          | 14          | 16          |
| 12 | 81,5  | 73,60  | 14          | 14          | 16          |
| 13 | 87,5  | 79,59  | 14          | 14          | 16          |
| 14 | 93,6  | 85,61  | 14          | 14          | 16          |
| 15 | 99,8  | 91,63  | 14          | 14          | 16          |
| 16 | 105,5 | 97,65  | 14          | 16          | 16          |
| 17 | 111,5 | 103,67 | 14          | 16          | 16          |
| 18 | 118,0 | 109,71 | 14          | 16          | 16          |
| 19 | 124,2 | 115,75 | 14          | 16          | 16          |
| 20 | 129,7 | 121,78 | 14          | 16          | 16          |
| 21 | 136,0 | 127,82 | 16          | 16          | 20          |
| 22 | 141,8 | 133,86 | 16          | 16          | 20          |
| 23 | 149,0 | 139,90 | 16          | 16          | 20          |
| 24 | 153,9 | 145,94 | 16          | 16          | 20          |
| 25 | 160,0 | 152,00 | 16          | 20          | 20          |
| 26 | 165,9 | 158,04 | 16          | 20          | 20          |
| 27 | 172,3 | 164,09 | 16          | 20          | 20          |
| 28 | 178,0 | 170,13 | 16          | 20          | 20          |
| 29 | 184,1 | 176,19 | 16          | 20          | 20          |
| 30 | 190,5 | 182,25 | 16          | 20          | 20          |
| 31 | 196,3 | 188,31 | 20          | 20          | 25          |
| 32 | 203,3 | 194,35 | 20          | 20          | 25          |
| 33 | 209,3 | 200,40 | 20          | 20          | 25          |
| 34 | 214,6 | 206,46 | 20          | 20          | 25          |
| 35 | 221,0 | 212,52 | 20          | 20          | 25          |
| 36 | 226,8 | 218,58 | 20          | 25          | 25          |
| 37 | 232,9 | 224,64 | 20          | 25          | 25          |
| 38 | 239,0 | 230,69 | 20          | 25          | 25          |
| 39 | 245,1 | 236,75 | 20          | 25          | 25          |
| 40 | 251,3 | 242,81 | 20          | 25          | 25          |
| 41 | 257,3 | 248,87 | 25          | 25          | 25          |
| 42 | 264,5 | 254,93 | 25          | 25          | 25          |
| 43 | 270,5 | 260,98 | 25          | 25          | 25          |

| Z   | De    | Dp     | 1 - rzędowe | 2 - rzędowe | 3 - rzędowe |
|-----|-------|--------|-------------|-------------|-------------|
|     |       |        | D           | D           | D           |
| 44  | 276,5 | 267,03 | 25          | 25          | 25          |
| 45  | 282,5 | 273,10 | 25          | 25          | 25          |
| 46  | 287,9 | 279,16 | 25          | 25          | 25          |
| 47  | 294,0 | 285,21 | 25          | 25          | 25          |
| 48  | 300,1 | 291,27 | 25          | 25          | 25          |
| 49  | 306,2 | 297,33 | 25          | 25          | 25          |
| 50  | 312,3 | 303,39 | 25          | 25          | 25          |
| 51  | 318,4 | 309,45 | 25          | 25          | 25          |
| 52  | 324,5 | 315,50 | 25          | 25          | 25          |
| 53  | 330,5 | 321,56 | 25          | 25          | 25          |
| 54  | 336,6 | 327,64 | 25          | 25          | 25          |
| 55  | 342,7 | 333,70 | 25          | 25          | 25          |
| 56  | 348,7 | 339,75 | 25          | 25          | 30          |
| 57  | 355,4 | 345,81 | 25          | 25          | 30          |
| 58  | 361,5 | 351,87 | 25          | 25          | 30          |
| 59  | 367,5 | 357,93 | 25          | 25          | 30          |
| 60  | 373,0 | 363,99 | 25          | 25          | 30          |
| 62  | 385,1 | 376,12 | 25          | 30          | 30          |
| 64  | 397,2 | 388,24 | 25          | 30          | 30          |
| 65  | 403,2 | 394,29 | 25          | 30          | 30          |
| 66  | 409,2 | 400,35 | 30          | 30          | 30          |
| 68  | 421,4 | 412,49 | 30          | 30          | 30          |
| 70  | 433,6 | 424,60 | 30          | 30          | 30          |
| 72  | 447,0 | 436,74 | 30          | 30          | 30          |
| 75  | 463,9 | 454,91 | 30          | 30          | 30          |
| 76  | 469,9 | 460,99 | 30          | 30          | 30          |
| 78  | 482,1 | 473,10 | 30          | 30          | 30          |
| 80  | 494,2 | 485,22 | 30          | 30          | 30          |
| 85  | 524,5 | 515,55 | 30          | 30          | 30          |
| 90  | 554,8 | 545,86 | 30          | 30          | 30          |
| 95  | 585,1 | 576,17 | 30          | 30          | 30          |
| 100 | 615,4 | 606,47 | 30          | 30          | 30          |
| 110 | 676,1 | 667,11 | 30          | 30          | 30          |
| 114 | 700,6 | 691,36 | 30          | 30          | 30          |
| 120 | 736,7 | 727,74 | 30          | 30          | 30          |
| 125 | 767,0 | 758,05 | 30          | 30          | 30          |

# KOŁA ŁAŃCUCHOWE TARCZOWE

1" x 17,02 mm 16B-1-2-3 25,4 x 17,02 mm

## ŁAŃCUCH

|        | Podziałka | Szerokość wew. | Rolka Ø |
|--------|-----------|----------------|---------|
| ISO mm | 25,47     | 17,02          | 15,88   |

## KOŁO ŁAŃCUCHOWE

|        | r    | C   | h <sub>1</sub> | L    | h <sub>2</sub> | h <sub>3</sub> | H |
|--------|------|-----|----------------|------|----------------|----------------|---|
| ISO mm | 26,0 | 2,5 | 16,2           | 15,8 | 47,7           | 79,6           | - |

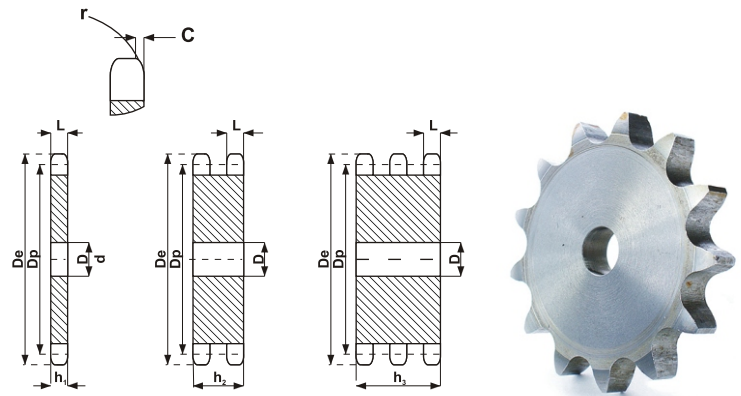

Mat. Stal C45 E UNI EN1083-1

ISO R606/ DIN 8187

| Z  | De    | Dp     | 1 - rzędowe | 2 - rzędowe | 3 - rzędowe |
|----|-------|--------|-------------|-------------|-------------|
|    |       |        | D           | D           | D           |
| 8  | 77,0  | 66,37  | 12          | 16          | 20          |
| 9  | 85,0  | 74,27  | 12          | 16          | 20          |
| 10 | 93,0  | 82,19  | 15          | 16          | 20          |
| 11 | 99,5  | 90,14  | 15          | 20          | 20          |
| 12 | 109,0 | 98,14  | 15          | 20          | 20          |
| 13 | 117,0 | 106,12 | 15          | 20          | 20          |
| 14 | 125,  | 114,15 | 15          | 20          | 20          |
| 15 | 133,0 | 122,17 | 15          | 20          | 20          |
| 16 | 141,0 | 130,20 | 19          | 20          | 30          |
| 17 | 149,0 | 138,22 | 19          | 20          | 30          |
| 18 | 157,0 | 146,28 | 19          | 20          | 30          |
| 19 | 165,2 | 154,33 | 19          | 20          | 30          |
| 20 | 173,2 | 162,38 | 19          | 20          | 30          |
| 21 | 181,2 | 170,43 | 20          | 25          | 30          |
| 22 | 189,3 | 178,48 | 20          | 25          | 30          |
| 23 | 197,5 | 186,53 | 20          | 25          | 30          |
| 24 | 205,5 | 194,59 | 20          | 25          | 30          |
| 25 | 213,5 | 202,66 | 20          | 25          | 30          |
| 26 | 221,6 | 210,72 | 20          | 25          | 30          |
| 27 | 229,6 | 218,79 | 20          | 25          | 30          |
| 28 | 237,7 | 226,85 | 20          | 25          | 30          |
| 29 | 245,8 | 234,92 | 20          | 25          | 30          |
| 30 | 254,0 | 243,00 | 20          | 25          | 30          |
| 31 | 262,0 | 251,08 | 25          | 25          | 30          |
| 32 | 270,0 | 259,13 | 25          | 25          | 30          |
| 33 | 278,5 | 267,21 | 25          | 25          | 30          |
| 34 | 287,0 | 275,28 | 25          | 25          | 30          |
| 35 | 296,2 | 283,36 | 25          | 25          | 30          |
| 36 | 304,6 | 291,44 | 25          | 25          | 30          |
| 37 | 312,6 | 299,51 | 25          | 25          | 30          |
| 38 | 320,7 | 307,59 | 25          | 25          | 30          |
| 39 | 328,8 | 315,67 | 25          | 25          | 30          |
| 40 | 336,9 | 323,73 | 25          | 25          | 03          |
| 41 | 345,0 | 331,82 | 25          | -           | -           |
| 42 | 353,0 | 339,90 | 25          | 25          | 30          |
| 43 | 361,1 | 347,98 | 25          | 25          | 30          |

| Z   | De     | Dp      | 1 - rzędowe | 2 - rzędowe | 3 - rzędowe |
|-----|--------|---------|-------------|-------------|-------------|
|     |        |         | D           | D           | D           |
| 44  | 369,1  | 356,06  | 25          | 25          | 30          |
| 45  | 377,1  | 364,12  | 25          | 25          | 30          |
| 46  | 385,2  | 372,21  | 25          | 25          | 30          |
| 47  | 393,2  | 380,29  | 25          | -           | -           |
| 48  | 401,3  | 388,36  | 25          | 30          | 30          |
| 49  | 409,3  | 396,44  | 25          | -           | -           |
| 50  | 417,4  | 404,52  | 25          | 30          | 30          |
| 51  | 425,5  | 412,60  | 30          | 30          | 40          |
| 52  | 433,6  | 420,67  | 30          | 30          | 40          |
| 53  | 441,7  | 428,75  | 30          | -           | -           |
| 54  | 448,3  | 436,85  | 30          | -           | -           |
| 55  | 457,9  | 444,93  | 30          | 30          | 40          |
| 56  | 466,0  | 453,01  | 30          | 30          | -           |
| 57  | 474,0  | 461,07  | 30          | 30          | 40          |
| 58  | 482,1  | 469,16  | 30          | -           | -           |
| 59  | 490,2  | 477,24  | 30          | -           | -           |
| 60  | 498,3  | 485,32  | 30          | 30          | 40          |
| 62  | 514,5  | 501,50  | 30          | 30          | -           |
| 64  | 530,7  | 517,65  | 30          | -           | -           |
| 65  | 538,8  | 525,73  | 30          | 30          | 40          |
| 66  | 546,8  | 533,80  | 30          | -           | -           |
| 68  | 562,9  | 549,98  | 30          | 30          | 40          |
| 70  | 579,2  | 566,14  | 30          | 30          | 40          |
| 72  | 595,4  | 582,32  | 30          | 30          | 40          |
| 75  | 619,7  | 606,55  | 30          | 30          | 40          |
| 76  | 627,0  | 614,65  | 30          | 30          | 40          |
| 78  | 643,3  | 630,80  | 30          | -           | -           |
| 80  | 660,0  | 646,96  | 30          | 30          | 40          |
| 85  | 699,9  | 687,40  | 30          | 30          | 40          |
| 90  | 740,3  | 727,81  | 30          | 30          | 40          |
| 95  | 781,1  | 768,22  | 30          | 30          | 40          |
| 100 | 821,1  | 808,63  | 30          | 30          | 40          |
| 110 | 902,0  | 889,48  | 30          | 30          | 40          |
| 114 | 934,3  | 921,81  | 30          | 40          | 40          |
| 120 | 982,8  | 970,33  | 30          | 40          | 40          |
| 125 | 1023,2 | 1010,73 | 30          | 40          | 40          |

# KOŁA ŁAŃCUCHOWE TARCZOWE

1"1/4 x 3/4" 20B-1-2-3 31,75 x 19,56 mm

## ŁAŃCUCH

|        | Podziałka | Szerokość wew. | Rolka Ø |
|--------|-----------|----------------|---------|
| ISO mm | 31,75     | 19,56          | 19,05   |

## KOŁO ŁAŃCUCHOWE

|        | r    | C   | h <sub>1</sub> | L    | h <sub>2</sub> | h <sub>3</sub> | H |
|--------|------|-----|----------------|------|----------------|----------------|---|
| ISO mm | 32,0 | 3,5 | 18,5           | 18,2 | 54,6           | 91,8           | - |

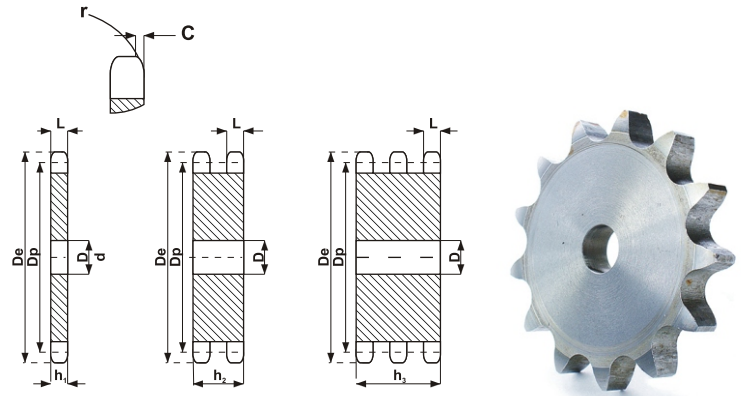

Mat. Stal C45 E UNI EN1083-1

ISO R606/ DIN 8187

| Z  | De    | Dp     | 1 - rzędowe | 2 - rzędowe | 3 - rzędowe |
|----|-------|--------|-------------|-------------|-------------|
|    |       |        | D           | D           | D           |
| 8  | 98,1  | 82,96  | 16          | 20          | 20          |
| 9  | 108,0 | 92,84  | 16          | 20          | 20          |
| 10 | 117,9 | 102,74 | 16          | 20          | 20          |
| 11 | 127,8 | 112,68 | 20          | 20          | 20          |
| 12 | 137,8 | 122,68 | 20          | 20          | 20          |
| 13 | 147,8 | 132,65 | 20          | 20          | 20          |
| 14 | 157,8 | 142,68 | 20          | 20          | 20          |
| 15 | 167,9 | 152,72 | 20          | 20          | 20          |
| 16 | 177,9 | 162,75 | 20          | 25          | 25          |
| 17 | 187,9 | 172,78 | 20          | 25          | 25          |
| 18 | 198,0 | 182,85 | 20          | 25          | 25          |
| 19 | 208,1 | 192,91 | 20          | 25          | 25          |
| 20 | 218,1 | 202,98 | 20          | 25          | 25          |
| 21 | 228,2 | 213,04 | 25          | 25          | 25          |
| 22 | 238,3 | 223,11 | 25          | 25          | 25          |
| 23 | 248,3 | 233,17 | 25          | 25          | 25          |
| 24 | 258,4 | 243,23 | 25          | 25          | 25          |
| 25 | 268,5 | 253,33 | 25          | 25          | 25          |
| 26 | 278,6 | 263,40 | 25          | 25          | 25          |
| 27 | 288,6 | 273,48 | 25          | 25          | 25          |
| 28 | 298,7 | 283,56 | 25          | 25          | 25          |
| 29 | 308,8 | 293,65 | 25          | 25          | 25          |
| 30 | 318,9 | 303,75 | 25          | 25          | 25          |
| 31 | 329,0 | 313,85 | 25          | 25          | 30          |
| 32 | 339,1 | 323,91 | 25          | 25          | 30          |
| 33 | 349,2 | 334,01 | 25          | 25          | 30          |
| 34 | 359,3 | 334,10 | 25          | 25          | 30          |
| 35 | 369,4 | 354,20 | 25          | 25          | 30          |
| 36 | 379,5 | 364,30 | 25          | 30          | 30          |
| 37 | 389,5 | 374,39 | 25          | 30          | 30          |
| 38 | 399,6 | 384,49 | 25          | 30          | 30          |
| 39 | 409,7 | 394,59 | 25          | 30          | 30          |
| 40 | 419,8 | 404,66 | 25          | 30          | 30          |
| 41 | 429,9 | 414,78 | 30          | -           | -           |
| 42 | 440,0 | 424,88 | 30          | 30          | 40          |
| 43 | 450,1 | 434,97 | 30          | -           | -           |

| Z   | De     | Dp      | 1 - rzędowe | 2 - rzędowe | 3 - rzędowe |
|-----|--------|---------|-------------|-------------|-------------|
|     |        |         | D           | D           | D           |
| 44  | 460,2  | 445,07  | 30          | -           | -           |
| 45  | 470,3  | 455,17  | 30          | 30          | 40          |
| 46  | 480,4  | 465,26  | 30          | 30          | 40          |
| 47  | 490,5  | 475,36  | 30          | -           | -           |
| 48  | 500,6  | 485,46  | 30          | 30          | 40          |
| 49  | 510,7  | 495,55  | 30          | -           | -           |
| 50  | 520,8  | 505,65  | 30          | 30          | 40          |
| 51  | 530,9  | 515,75  | 30          | -           | -           |
| 52  | 541,0  | 525,84  | 30          | 30          | 40          |
| 53  | 551,1  | 535,94  | 30          | -           | -           |
| 54  | 561,2  | 546,07  | 30          | -           | -           |
| 55  | 571,3  | 556,16  | 30          | 30          | 40          |
| 56  | 581,4  | 566,26  | 30          | -           | -           |
| 57  | 591,5  | 576,36  | 30          | 30          | 40          |
| 58  | 601,6  | 586,45  | 30          | -           | -           |
| 59  | 611,7  | 596,55  | 30          | -           | -           |
| 60  | 621,8  | 606,65  | 30          | 30          | 40          |
| 62  | 642,0  | 626,87  | 30          | -           | -           |
| 64  | 662,2  | 647,06  | 30          | -           | -           |
| 65  | 672,3  | 657,16  | 30          | 30          | 40          |
| 66  | 682,4  | 667,26  | 30          | -           | -           |
| 68  | 702,6  | 687,48  | 30          | -           | -           |
| 70  | 722,8  | 707,67  | 30          | 30          | 40          |
| 72  | 743,1  | 727,90  | 30          | -           | -           |
| 75  | 773,3  | 758,19  | 30          | -           | -           |
| 76  | 783,5  | 768,32  | 30          | 30          | 40          |
| 80  | 823,9  | 808,72  | 30          | 30          | 40          |
| 85  | 874,4  | 859,25  | 30          | -           | -           |
| 90  | 924,9  | 909,76  | 30          | -           | -           |
| 95  | 975,2  | 960,28  | 30          | 30          | 40          |
| 100 | 1026,0 | 1010,79 | 30          | -           | -           |
| 114 | 1167,4 | 1152,26 | 30          | 30          | 40          |

# KOŁA ŁAŃCUCHOWE TARCZOWE

1 1/2 x 1" 24B-1-2-3 38,1 x 5,72 mm

## ŁAŃCUCH

|        | Podziałka | Szerokość wew. | Rolka Ø |
|--------|-----------|----------------|---------|
| ISO mm | 38,1      | 25,4           | 25,4    |

## KOŁO ŁAŃCUCHOWE

|        | r    | C   | h <sub>1</sub> | L    | h <sub>2</sub> | h <sub>3</sub> | H |
|--------|------|-----|----------------|------|----------------|----------------|---|
| ISO mm | 38,0 | 4,5 | 24,1           | 23,6 | 72,7           | 120,3          | - |

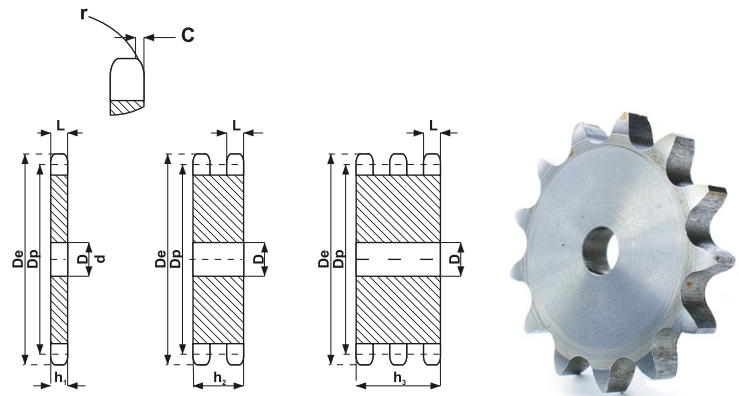

Mat. Stal C45 E UNI EN1083-1

ISO R606/ DIN 8187

| Z  | De    | Dp     | 1 - rzędowe | 2 - rzędowe | 3 - rzędowe |
|----|-------|--------|-------------|-------------|-------------|
|    |       |        | D           | D           | D           |
| 8  | 115,0 | 99,55  | 20          | 25          | 25          |
| 9  | 126,4 | 111,40 | 20          | 25          | 25          |
| 10 | 138,0 | 123,29 | 20          | 25          | 25          |
| 11 | 150,0 | 135,21 | 20          | 25          | 25          |
| 12 | 162,0 | 147,22 | 20          | 25          | 25          |
| 13 | 174,2 | 159,18 | 20          | 25          | 25          |
| 14 | 186,2 | 171,22 | 20          | 25          | 25          |
| 15 | 198,2 | 183,26 | 20          | 25          | 25          |
| 16 | 210,3 | 195,30 | 25          | 25          | 25          |
| 17 | 222,3 | 207,34 | 25          | 25          | 25          |
| 18 | 234,3 | 219,42 | 25          | 25          | 25          |
| 19 | 246,5 | 231,49 | 25          | 25          | 25          |
| 20 | 258,6 | 243,57 | 25          | 25          | 25          |
| 21 | 270,6 | 255,65 | 25          | 25          | 30          |
| 22 | 282,7 | 267,73 | 25          | 25          | 30          |
| 23 | 294,8 | 279,80 | 25          | 25          | 30          |
| 24 | 306,8 | 291,88 | 25          | 25          | 30          |
| 25 | 319,0 | 304,00 | 25          | 25          | 30          |
| 26 | 331,0 | 316,08 | 30          | 30          | 30          |
| 27 | 343,2 | 328,19 | 30          | 30          | 30          |
| 28 | 355,2 | 340,27 | 30          | 30          | 30          |
| 29 | 367,3 | 352,38 | 30          | 30          | 30          |
| 30 | 379,5 | 364,50 | 30          | 30          | 40          |
| 31 | 391,6 | 376,62 | 30          | 40          | 40          |
| 32 | 403,7 | 388,69 | 30          | 40          | 40          |
| 33 | 415,8 | 400,81 | 30          | 40          | 40          |
| 34 | 427,8 | 412,93 | 30          | 40          | 40          |
| 35 | 440,0 | 425,04 | 30          | 40          | 40          |
| 36 | 452,0 | 437,16 | 30          | 40          | 40          |
| 37 | 464,2 | 449,27 | 30          | 40          | 40          |
| 38 | 476,2 | 461,39 | 30          | 40          | 40          |
| 39 | 488,5 | 473,50 | 30          | 40          | 40          |
| 40 | 500,6 | 485,62 | 30          | 40          | 40          |
| 41 | 512,6 | 497,74 | 30          | -           | -           |
| 42 | 524,7 | 509,85 | 30          | 40          | 40          |
| 43 | 536,8 | 521,97 | 30          | -           | -           |

| Z  | De     | Dp      | 1 - rzędowe | 2 - rzędowe | 3 - rzędowe |
|----|--------|---------|-------------|-------------|-------------|
|    |        |         | D           | D           | D           |
| 44 | 549,0  | 534,08  | 30          | -           | -           |
| 45 | 561,2  | 546,20  | 30          | 40          | 40          |
| 46 | 573,3  | 558,32  | 30          | 40          | 40          |
| 47 | 585,4  | 570,43  | 30          | -           | -           |
| 48 | 597,4  | 582,55  | 30          | 40          | 40          |
| 49 | 609,5  | 594,66  | 30          | -           | -           |
| 50 | 621,7  | 606,78  | 30          | 40          | 40          |
| 51 | 633,8  | 618,89  | 30          | -           | -           |
| 52 | 646,0  | 631,01  | 30          | -           | -           |
| 53 | 658,0  | 643,13  | 30          | -           | -           |
| 54 | 670,2  | 655,25  | 30          | -           | -           |
| 55 | 682,3  | 667,40  | 30          | 40          | 40          |
| 56 | 694,4  | 679,50  | 30          | -           | -           |
| 57 | 706,5  | 691,73  | 30          | 40          | 40          |
| 58 | 718,6  | 703,74  | 30          | -           | -           |
| 59 | 730,7  | 715,86  | 30          | -           | -           |
| 60 | 742,8  | 727,97  | 30          | 40          | 40          |
| 62 | 767,2  | 752,24  | 40          | -           | -           |
| 64 | 791,3  | 776,48  | 40          | -           | -           |
| 65 | 803,4  | 788,59  | 40          | 40          | 40          |
| 66 | 815,6  | 800,17  | 40          | -           | -           |
| 68 | 839,8  | 824,98  | 40          | -           | -           |
| 70 | 864,2  | 849,21  | 40          | -           | -           |
| 72 | 888,4  | 873,48  | 40          | -           | -           |
| 75 | 924,8  | 909,83  | 40          | -           | -           |
| 76 | 936,9  | 921,98  | 40          | 40          | 40          |
| 80 | 985,4  | 970,44  | 40          | -           | -           |
| 85 | 1046,0 | 1031,10 | 40          | -           | -           |
| 95 | 1167,3 | 1152,33 | 40          | -           | -           |

# KOŁA ŁAŃCUCHOWE TARCZOWE

1 3/4 x 1 1/4 28B-1-2-3 44,45 x 30,99 mm

## ŁAŃCUCH

|        | Podziałka | Szerokość wew. | Rolka Ø |
|--------|-----------|----------------|---------|
| ISO mm | 44,45     | 30,99          | 27,94   |

## KOŁO ŁAŃCUCHOWE

|        | r    | C   | h <sub>1</sub> | L    | h <sub>2</sub> | h <sub>3</sub> | H |
|--------|------|-----|----------------|------|----------------|----------------|---|
| ISO mm | 44,0 | 5,5 | 29,4           | 28,8 | 88,4           | 148,8          | - |

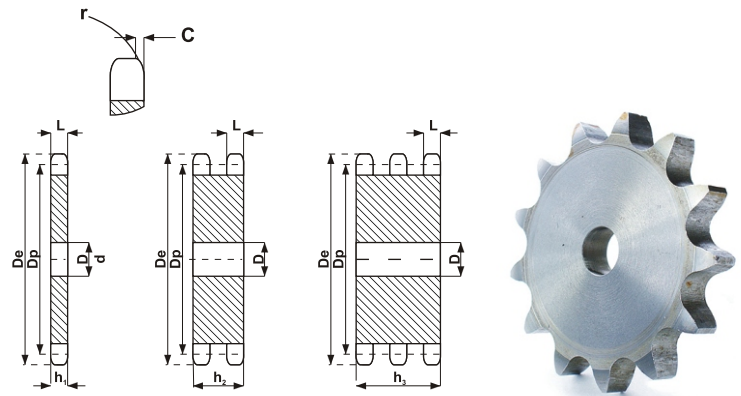

Mat. Stal C45 E UNI EN1083-1

ISO R606/ DIN 8187

| Z  | De    | Dp     | 1 - rzędowe | 2 - rzędowe | 3 - rzędowe |
|----|-------|--------|-------------|-------------|-------------|
|    |       |        | D           | D           | D           |
| 8  | 132,0 | 116,15 | 25          | 25          | 25          |
| 9  | 148,4 | 129,96 | 25          | 25          | 25          |
| 10 | 162,3 | 143,85 | 25          | 25          | 25          |
| 11 | 176,3 | 157,77 | 25          | 25          | 30          |
| 12 | 189,3 | 171,74 | 25          | 25          | 30          |
| 13 | 204,2 | 185,75 | 25          | 25          | 30          |
| 14 | 218,2 | 199,76 | 25          | 25          | 30          |
| 15 | 232,3 | 213,79 | 25          | 25          | 30          |
| 16 | 246,3 | 227,85 | 30          | 30          | 30          |
| 17 | 260,0 | 241,90 | 30          | 30          | 30          |
| 18 | 274,0 | 255,98 | 30          | 30          | 30          |
| 19 | 289,0 | 270,06 | 30          | 30          | 30          |
| 20 | 303,0 | 284,15 | 30          | 30          | 30          |
| 21 | 317,0 | 298,24 | 30          | 30          | 30          |
| 22 | 331,0 | 312,34 | 30          | 30          | 30          |
| 23 | 345,0 | 326,44 | 30          | 30          | 30          |
| 24 | 359,0 | 340,55 | 30          | 30          | 30          |
| 25 | 373,0 | 354,66 | 30          | 30          | 40          |
| 26 | 387,0 | 368,77 | 30          | 30          | 40          |
| 27 | 401,0 | 382,88 | 30          | 30          | 40          |
| 28 | 416,0 | 397,00 | 30          | 30          | 40          |
| 29 | 430,0 | 411,12 | 30          | 30          | 40          |
| 30 | 444,0 | 425,24 | 30          | 30          | 40          |
| 31 | 458,0 | 439,37 | 30          | 30          | 40          |
| 32 | 472,0 | 453,49 | 30          | 30          | 40          |
| 33 | 486,0 | 467,62 | 30          | 30          | 40          |
| 34 | 500,0 | 481,75 | 30          | 30          | 40          |
| 35 | 514,0 | 495,88 | 30          | 30          | 40          |
| 36 | 529,0 | 510,01 | 30          | 30          | 40          |
| 37 | 543,0 | 524,13 | 30          | 30          | 40          |
| 38 | 557,0 | 538,24 | 30          | 30          | 40          |
| 39 | 571,0 | 552,40 | 30          | 30          | 40          |
| 40 | 585,0 | 566,54 | 30          | 30          | 40          |

| Z  | De     | Dp      | 1 - rzędowe | 2 - rzędowe | 3 - rzędowe |
|----|--------|---------|-------------|-------------|-------------|
|    |        |         | D           | D           | D           |
| 45 | 656,0  | 637,22  | 30          | 30          | 40          |
| 50 | 726,0  | 707,91  | 30          | 30          | 40          |
| 57 | 825,0  | 806,90  | 40          | 40          | 40          |
| 60 | 869,0  | 849,32  | 40          | 40          | 40          |
| 76 | 1095,0 | 1075,62 | 40          | 40          | 40          |



# KOŁA ŁAŃCUCHOWE TARCZOWE

2" x 1"1/4 32B-1-2-3 50,8 x 30,99 mm

## ŁAŃCUCH

|        | Podziałka | Szerokość wew. | Rolka Ø |
|--------|-----------|----------------|---------|
| ISO mm | 50,80     | 30,99          | 29,21   |

## KOŁO ŁAŃCUCHOWE

|        | r    | C   | h <sub>1</sub> | L    | h <sub>2</sub> | h <sub>3</sub> | H |
|--------|------|-----|----------------|------|----------------|----------------|---|
| ISO mm | 51,0 | 6,5 | 29,4           | 28,8 | 87,4           | 146,3          | - |

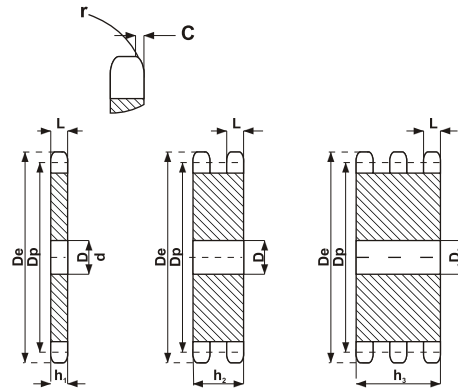

Mat. Stal C45 E UNI EN1083-1

ISO R606/ DIN 8187

| Z  | De     | Dp      | 1 - rzędowe | 2 - rzędowe | 3 - rzędowe |
|----|--------|---------|-------------|-------------|-------------|
|    |        |         | D           | D           | D           |
| 8  | 153,2  | 132,74  | 25          | 25          | 25          |
| 9  | 169,0  | 148,54  | 25          | 25          | 25          |
| 10 | 185,0  | 164,39  | 25          | 25          | 25          |
| 11 | 200,8  | 180,31  | 30          | 30          | 30          |
| 12 | 216,8  | 196,29  | 30          | 30          | 30          |
| 13 | 232,8  | 212,29  | 30          | 30          | 30          |
| 14 | 248,8  | 228,29  | 30          | 30          | 30          |
| 15 | 264,8  | 244,30  | 30          | 30          | 30          |
| 16 | 280,9  | 260,40  | 30          | 30          | 30          |
| 17 | 296,9  | 276,46  | 30          | 30          | 30          |
| 18 | 313,0  | 292,55  | 30          | 30          | 30          |
| 19 | 329,1  | 308,66  | 30          | 30          | 30          |
| 20 | 345,2  | 324,71  | 30          | 30          | 30          |
| 21 | 361,3  | 340,82  | 30          | 30          | 40          |
| 22 | 377,5  | 356,98  | 30          | 30          | 40          |
| 23 | 393,6  | 373,08  | 30          | 30          | 40          |
| 24 | 409,7  | 389,18  | 30          | 30          | 40          |
| 25 | 425,8  | 405,33  | 30          | 30          | 40          |
| 26 | 441,9  | 421,44  | 30          | 30          | 40          |
| 27 | 458,1  | 437,59  | 30          | 30          | 40          |
| 28 | 474,2  | 453,69  | 30          | 30          | 40          |
| 29 | 492,0  | 469,85  | 30          | 30          | 40          |
| 30 | 506,5  | 486,00  | 30          | 30          | 40          |
| 32 | 538,8  | 518,27  | 30          | -           | -           |
| 35 | 589,5  | 566,71  | 30          | 30          | 40          |
| 38 | 635,5  | 615,16  | 30          | 30          | 40          |
| 40 | 670,3  | 647,47  | 40          | 40          | 40          |
| 45 | 751,0  | 728,24  | 40          | 40          | 40          |
| 50 | 831,8  | 809,04  | 40          | 40          | 40          |
| 57 | 945,0  | 922,16  | 40          | 40          | 40          |
| 60 | 993,4  | 970,65  | 40          | 40          | 40          |
| 76 | 1252,0 | 1229,27 | 40          | 40          | 40          |